

MULTIWASH PRO STEAM: DESCALING YOUR MACHINE

THIS USER GUIDE SHOULD ALWAYS BE USED IN CONJUNCTION WITH THE USER MANUAL



WARNING:

REGULAR DESCALING MUST BE CARRIED OUT TO AVOID DAMAGE AND VOIDING THE MANUFACTURER'S WARRANTY.

SCAN QR CODE FOR INSTRUCTIONS

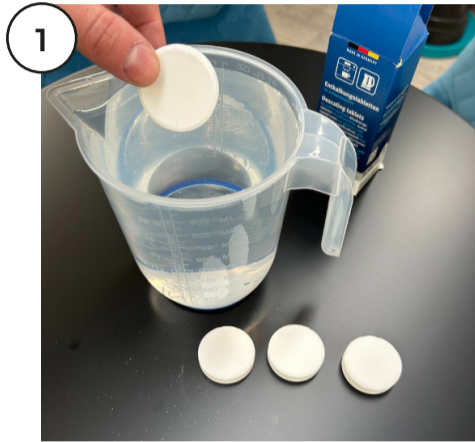

1 Place the MWPRO Steam machine on a waterproof or draining mat.

Dissolve 4 descaling tablets in 1 litre of water.



2 Keep the machine in transport mode and pour the descaling solution into the tank.



3 Turn on the heater to start the steam. Wait 10-15 minutes for the solution to run through and empty the tank.

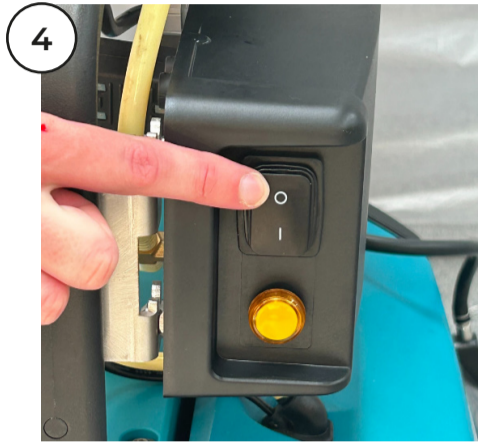

4 Once the steam output has stopped, Switch OFF the heater.



5 Fill the solution tank with 1 litre of clean water.



6 Turn on the heater to start the steam. Wait 10-15 minutes for the water to run through and empty the tank.

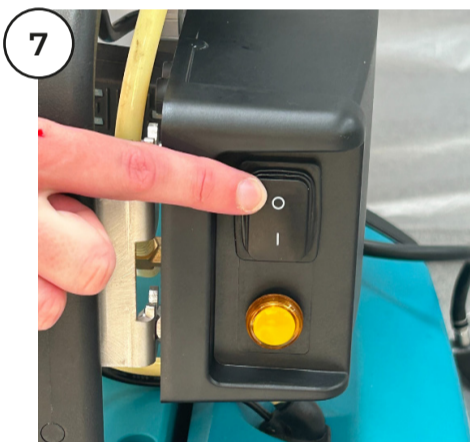

7 Switch OFF the heater.



8 Once cooled, wipe down and clean the machine. Store in a dry, indoor area only.

MULTIWASH PRO STEAM USER GUIDE

THIS USER GUIDE SHOULD ALWAYS BE USED IN CONJUNCTION WITH THE USER MANUAL

1. ASSEMBLING THE MACHINE



1 Insert the top handle into the bottom, ensuring the cable hooks face the rear of the machine.

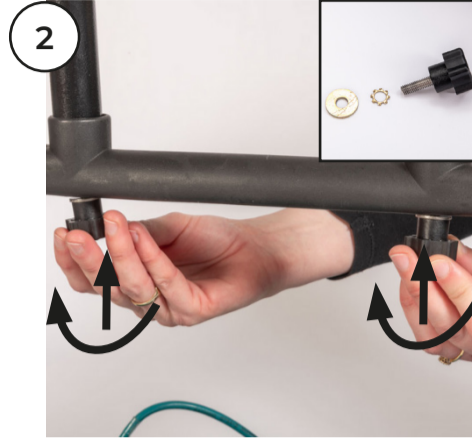

2 Secure the handle tubes using the 4 washers and 2 knobs and hand tighten.



3 Connect the pump spray cable to the top handle and locate into position on the handle guides.

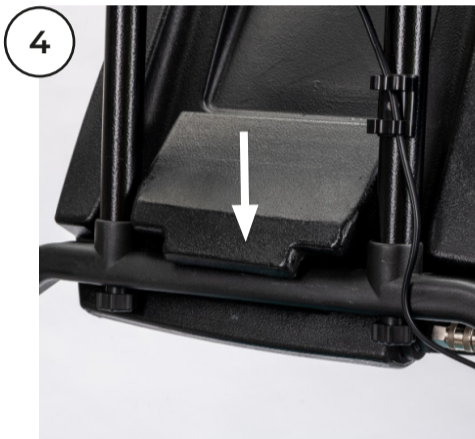

4 Position the solution tank into place, ensuring it hooks over the bottom handle and locks into position at the top of the tank.

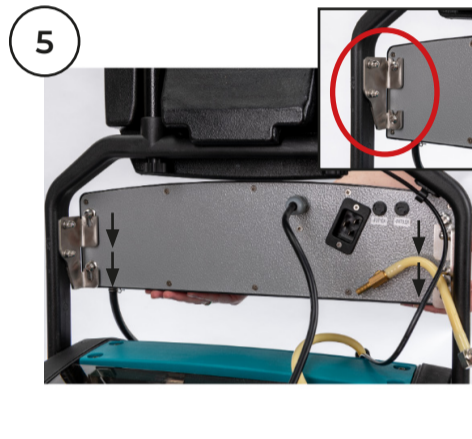

5 Secure the steam box on the four latches.

Cables should face the rear of the machine.

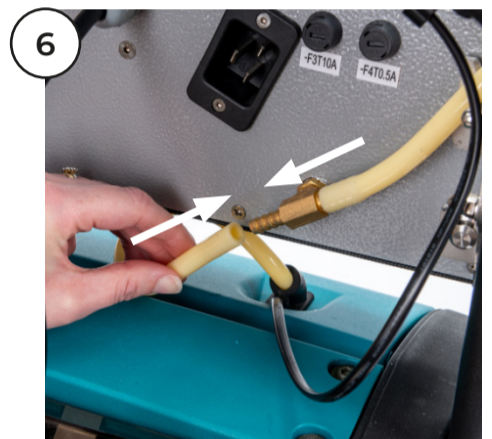

6 Connect the pump hose to the barb on the rear of the steam box unit.



7 Connect the water feed hose into the solution tank connector.

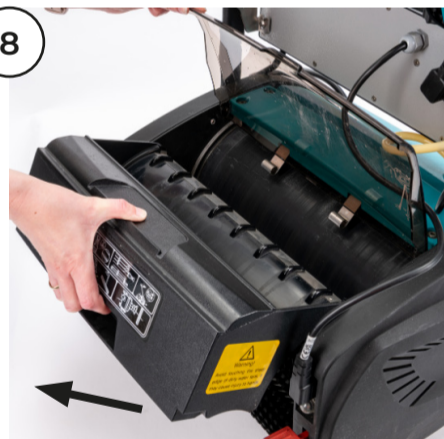

8 Lift the clear plastic lid at the back of the machine and remove the recovery tank.

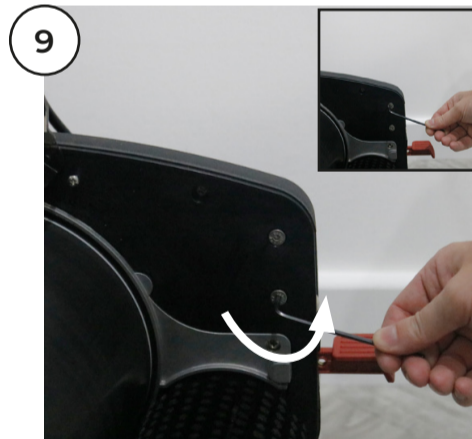

9 With an allen key, loosen the 2 screws left of the power cord connection.



10 Attach the power cord, ensuring it is connected correct and re-tighten the 2 screws.



11 Plug the power cord into the steam box unit.



12 Feed the power cord through the cable restraint on the handle and wrap the power cord around the handle cord hooks.



13 Slide the steam bar onto the front of the machine and position the steam shield onto the steam bar by locating the lower section to the steam bar first and then pushing the shield towards the machine.



MULTIWASH PRO STEAM USER GUIDE

THIS USER GUIDE SHOULD ALWAYS BE USED IN CONJUNCTION WITH THE USER MANUAL



Remove the black cap from the top of the steam bar and connect the steam hose to the barb and secure with the clamp.

Insert the pressure release hose into the rubber housing on the shield assembly.

2. PREPARING & USING THE MACHINE



Release the supply cord by turning the cable holding hooks inwards.

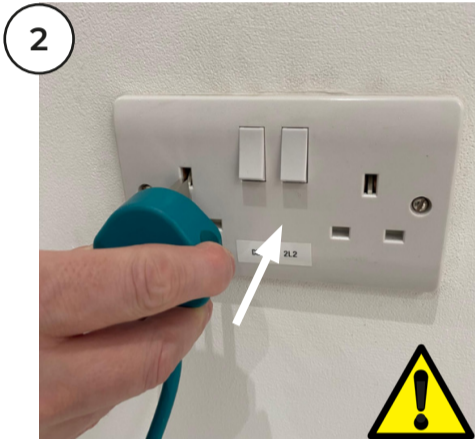

Plug the machine into a convenient socket outlet.



Fill the solution tank with clean water only.

This machine should NOT be used with cleaning chemicals.

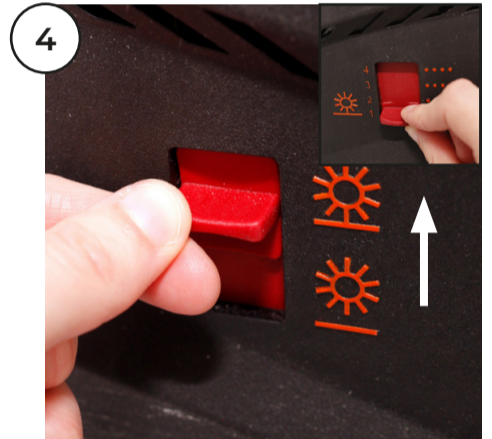

Change the machine to working mode.

Select the brush pressure required using the slider on the side of the machine.



Switch on the steam unit - the illuminated light will switch on. It will take approximately a minute to heat and during this time water will release onto the floor.



To start the machine, press the foot pedal lightly and pull back the handle. You can start the machine and commence cleaning as the machine heats up.

The Multiwash PRO Steam should be used in a forward motion only, taking a U-turn to go back over the cleaning path.



Once finished, switch off the steam unit at approximately 30 cm before the end of the cleaning path and continue to move to the end of the cleaning path to ensure all water is picked up. To stop the machine, bring the handle back up to the upright position.

3. FOR NON-STEAM APPLICATIONS

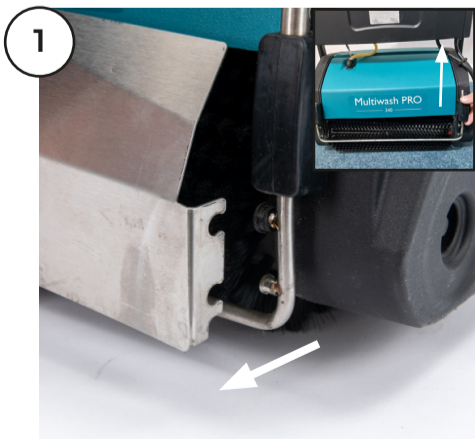

Remove the steam shield and lift off the steam bar.



To start the machine, press the foot pedal lightly and pull back the handle.

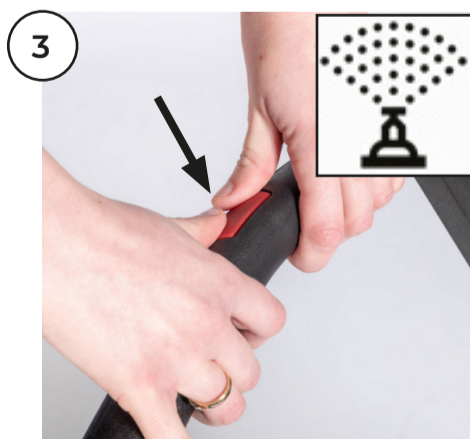

Press the button on the handle to release the water onto the floor.

Stop dispensing the solution approximately 30cm before the end of the cleaning path and continue to move to the end of the cleaning path to ensure all water is picked up.

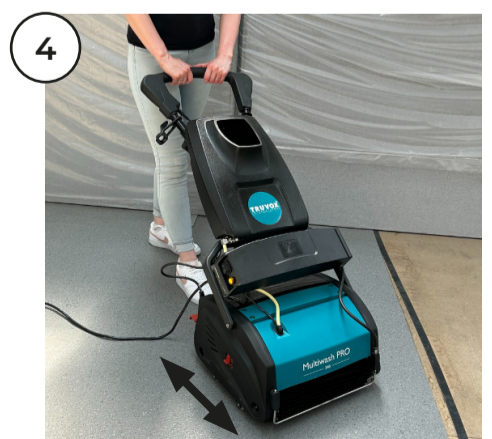

MULTIWASH PRO STEAM USER GUIDE

THIS USER GUIDE SHOULD ALWAYS BE USED IN CONJUNCTION WITH THE USER MANUAL

4. AFTER USE & STORAGE

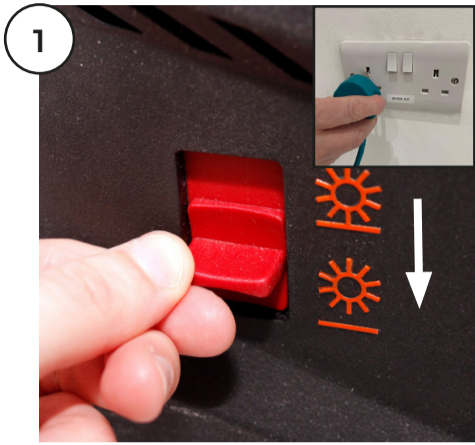

Put the machine in transport mode and unplug the machine.



Wrap the power cord around the handle cord hooks.

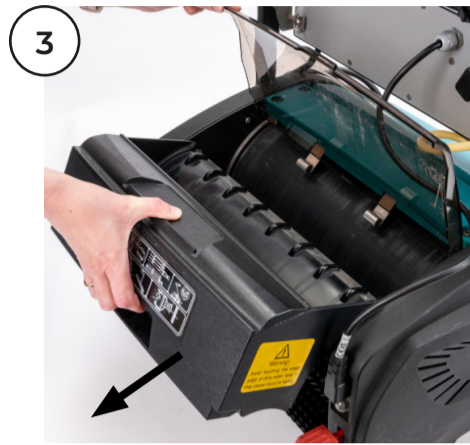

Once the machine has cooled down, remove, rinse and dry the recovery tank and replace.



Disconnect the water feed hose from the solution tank connector.



Remove, rinse with clean water and dry the solution tank.
Replace the solution tank onto the machine and reconnect the hose.

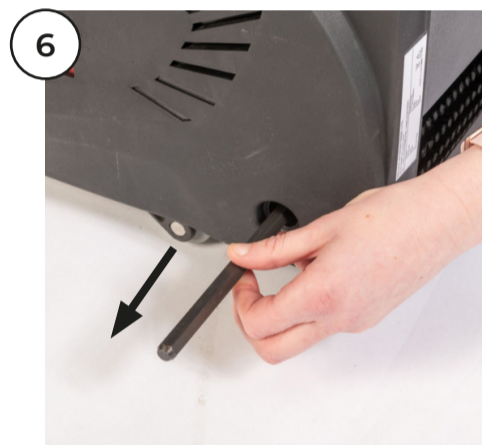

To remove brushes, push the brush rod on either side and slide out the brush.

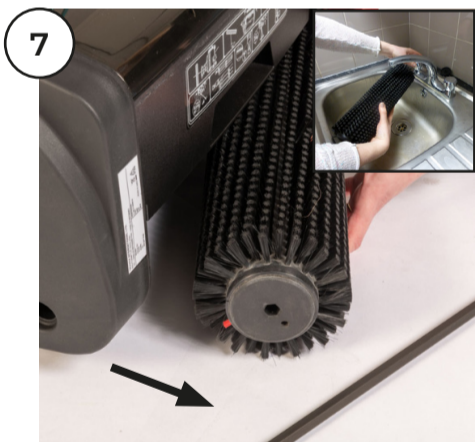

Brushes should be checked regularly for any wear and tear. The brush indicator shows when brushes are due for replacing. Replace both brushes at the same time.



Wipe down the machines including the drum roll.



Store in a dry, indoor area only.

5. MOTOR OVERLOAD



If the machine overheats, the overload protector will trip. Unplug the machine and identify the problem. Once corrected, plug the machine into a socket outlet and reset the motor overload button after a minimum of 30 seconds.

